

**Notice of landowner deposits under section 31(6) of the Highways Act 1980  
and section 15A(1) of the Commons Act 2006  
DERBYSHIRE COUNTY COUNCIL**

An application to deposit a map and statement under section 31(6) of the Highways Act 1980 has been made in relation to the land (or lands) described below and shown edged red on the accompanying map.

**PLEASE NOTE:**

This deposit may affect rights over the land described below. Deposits made under section 31(6) of the Highways Act 1980 may prevent deemed dedication of public rights of way over such land under section 31(1) of that Act.

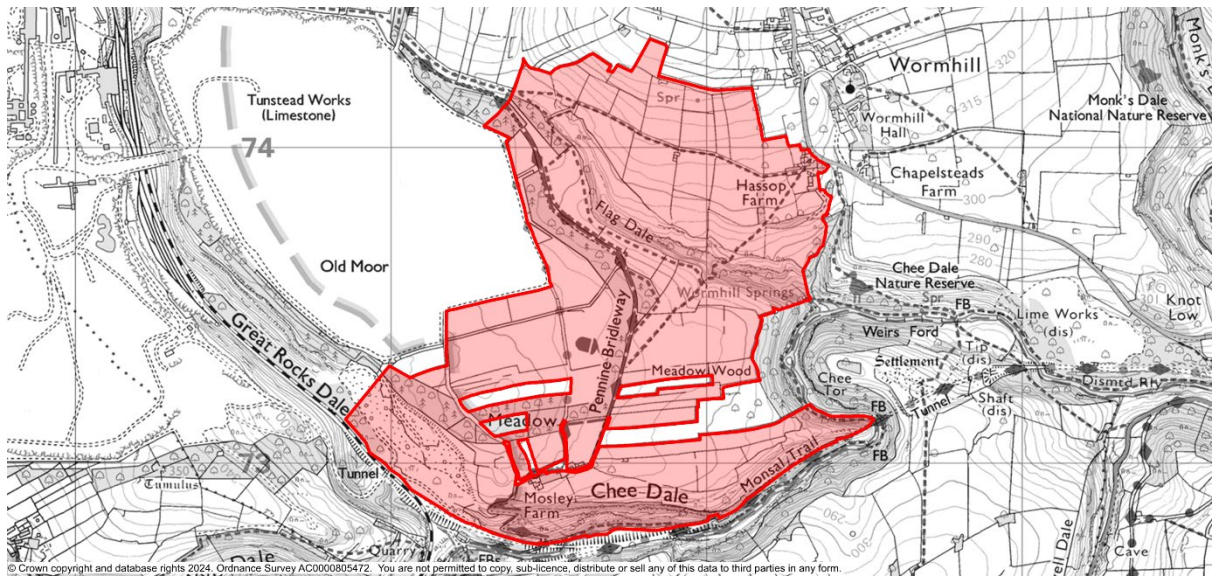

**Description of the land(s):**

Land at Flag Dale, Tunstead, Buxton, Derbyshire, SK17 8TD

**Name of the Parish, Ward or District in which the land is situated:**

Wormhill / Buxton

The deposit was submitted by Henry Walker MRICS, Fisher German LLP, The Estates Office, Norman Court, Ashby De La Zouch, Leicestershire, LE65 2UZ.

The authority maintains a register of maps, statements and declarations deposited under section 31A of the Highways Act 1980 and section 15B of the Commons Act 2006. The register for landowner deposits can be accessed online at [rights of way declaration register](#). Alternatively the registers can be inspected free of charge at the offices of the Director of Legal Services, Derbyshire County Council, County Hall, Matlock, Derbyshire DE4 3AG between the hours of 9.00am and 5.00pm.

Signed on behalf of **Derbyshire County Council**

Helen Barrington  
Director of Legal Services

Date: 26 July 2024